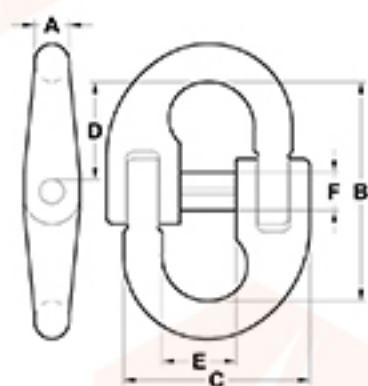

U.S. TYPE G80 CONNECTING LINK

YXR1029

ITEM NO.	CHAIN SIZE		WLL (LBS.)	WEIGHT (LBS.)	DIMENSIONS (IN.)					
	(IN.)	(MM)			A	B	C	D	E	F
YXR1029-01	1/4	7	4300	0.26	0.38	1.94	1.90	0.81	0.69	0.57
YXR1029-02	5/16	8	5700	0.35	0.37	2.35	2.07	0.99	0.72	0.64
YXR1029-03	3/8	10	8800	0.75	0.48	2.70	2.47	1.12	0.90	0.78
YXR1029-04	1/2	13	15000	1.60	0.68	3.45	3.31	1.44	1.12	0.97
YXR1029-05	5/8	16	22600	2.68	0.81	4.13	3.90	1.72	1.35	1.14
YXR1029-06	3/4	20	35300	5.00	0.93	4.62	4.62	2.03	1.62	1.28
YXR1029-07	7/8	22	42700	7.50	1.06	5.46	5.46	2.27	2.00	1.49
YXR1029-08	1	25	59700	11.03	1.22	5.98	6.13	2.44	2.25	1.76
YXR1029-09	1-1/4	32	90400	20.38	1.50	7.43	7.59	3.07	2.56	2.23

◆ Ultimate Load at 4 Times the Working Load Limit.

G80 WEB SLING CONNECTOR

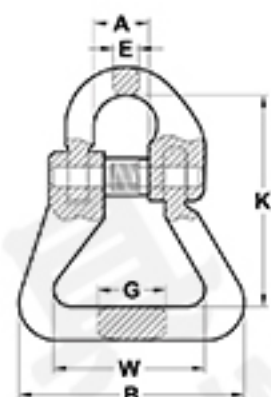
YXR1030

ITEM NO.	SIZE	WEIGHT (KG)	WLL (T)	BLL (T)	DIMENSIONS (MM)					
					A ± 1.5	B ± 2	K ± 1	W ± 2	G ± 1	E ± 1
YXR1030-01	6	0.2	1.12	4.48	15	60	56	40	18	7
YXR1030-02	7/8	0.3	2.0	8.0	20	61.5	63.7	40	24	9.5
YXR1030-03	10	0.68	3.15	12.6	24	66	83	39	30.5	11
YXR1030-04	13	1.47	2.3	21.2	28	88	93.7	55	36.8	16.5
YXR1030-05	16	2.3	8	32	34.5	108	120	65.5	45.2	19.8
YXR1030-06	20	3.3	12.5	50	41	129	138	80	51.8	23
YXR1030-07	22	6.89	15	60	50	191	180	126	70	26
YXR1030-08	26	10.62	21.2	84.8	58	228.4	209.5	152	86	30
YXR1030-09	32	18.92	31.5	126	72.5	252	279	160	91	55

◆ Ultimate Load at 4 Times the Working Load Limit.

EUROPEAN TYPE G80 CONNECTING LINK

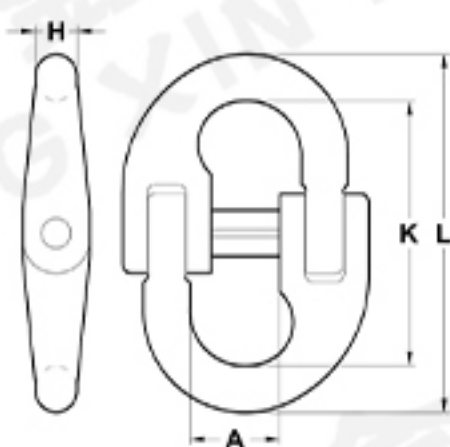
YXR1031

ITEM NO.	SIZE (MM)	WLL (T)	BLL (T)	WEIGHT (KG)	DIMENSIONS (MM)			
					A ± 1.5	L ± 2.5	K ± 2	H ± 1
YXR1031-01	6-8	1.12	4.48	0.08	15	58	42	7
YXR1031-02	7-8	1.5	6	0.145	19	71.8	54.8	8.5
YXR1031-03	7/8-8	2	8	0.146	18	79.5	60.5	8.5
YXR1031-04	8-8	2	8	0.16	19.5	79.5	60.5	8.5
YXR1031-05	10-8	3.15	12.6	0.30	25	90.5	68	11.5
YXR1031-06	13-8	5.3	21.2	0.65	29	117	87	15
YXR1031-07	16-8	8	32	1.15	34.5	148	108.4	19.8
YXR1031-08	18-8	10	40	1.84	38	154	112	21
YXR1031-09	20-8	12.5	50	2.1	41	169.5	121.5	24
YXR1031-10	22-8	15	60	2.87	48	193.5	141.5	26
YXR1031-11	26-8	21.2	84.8	4.5	57.5	220	158	30
YXR1031-12	32-8	31.5	126	8.21	67	281	205	37

◆ Ultimate Load at 4 Times the Working Load Limit.